



SNAP Full Function Digital Measuring Machine

QVI® SNAP™ may be the most productive machine in your shop. SNAP's advanced video imaging technology allows measurement of entire parts at the touch of a button.

Get the Big Picture

SNAP's telecentric optics have a generous 78mm field of view, and a large focal range, allowing a wide range of part sizes and shapes to be measured. With 75mm of vertical worktable adjustment, SNAP has the measurement volume to handle a wide variety of parts.

High Definition Video

A digital megapixel camera provides high definition video images. Advanced image processing lets you zoom in on any part of the field of view to isolate and measure small details with up to 50 nanometer resolution — without moving the part.

Flexible Illumination

SNAP includes three LED lighting systems: Backlight for profile projection, square-on top light for looking into bores and cavities, and an 8-sector bi-color ring light for highlighting surface features. Get the perfect lighting for every part.



Lighting flexibility

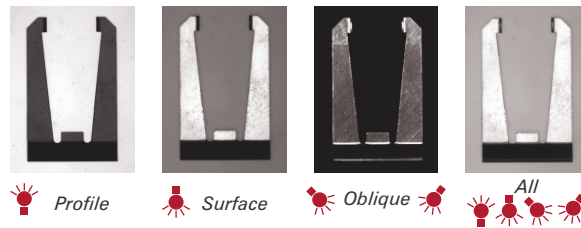

Measure-X 2D - The Ultimate in Capability

Measure-X® 2D metrology software provides a full range of feature measurements with unlimited numbers of points or measurement steps in a routine.

To run a part routine, just place the part and press ►. The unique Autocorrelate function in Measure-X 2D automatically locates the part and its orientation, eliminating the need for any manual setup.

Programming is simple too. Work from a CAD drawing, sample part, or just walk up and measure - SNAP.

A simple give & take...

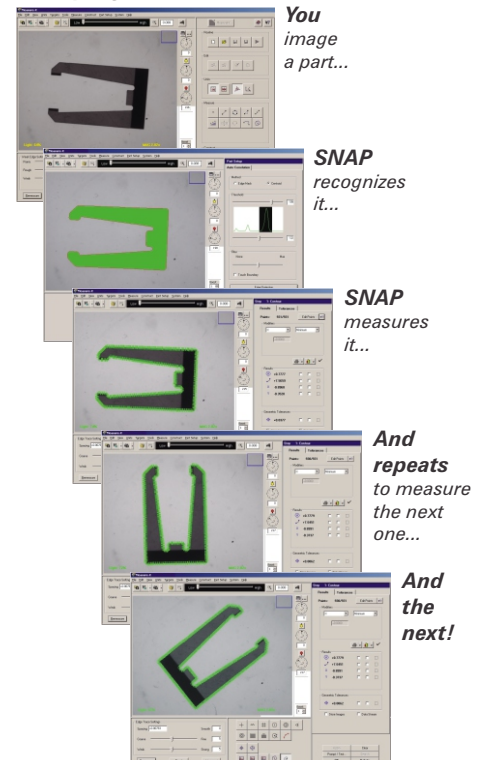



SNAP Features & Technical Specifications

- Measuring unit** Cast aluminum base with nickel plated worktable with manually adjustable 75 mm vertical position adjustment and stage lock
- Optics** Fully telecentric, fixed lens, calibration artifact included
- Field of View** 78 mm to 9.75 mm (diagonal), in 8 digital zoom steps
- XY Measuring Depth of Field** 38 mm at Low Mag; 4.75 mm at High Mag
- Camera** QVI digital megapixel, black & white, pixel size 2.2 μ m
- Illumination** All-LED, substage profile (green), coaxial surface (green), programmable 8-sector ring light (red, green, or combination selectable by sector)
- Controller (Minimum specs)** Intel® Quad-Core processor, 4 GB RAM, 160 GB hard drive, Windows™ Operating System
- Controller accessories (opt)** Single flat panel LCD monitor, or dual flat panel LCD monitors; keyboard, mouse (or user supplied)
- Minimum monitor resolution** 1920x1080 on widescreen 16:9 monitor
1600x1200 on standard 4:3 monitor
1680x1050 on widescreen 16:10 monitor
- Software** Measure-X® 2D metrology software
- Image processing** SNAP advanced image analysis, 256 level grayscale, with 10:1 - 50:1 sub-pixel resolution
- Temperature** 20 \pm 2° C (Rated), 15 - 30° C (Safe Operating)
- Power** 85~264 vac, 47~63 Hz, 1 phase, 160 W
- Worktable** 10 Kg load capacity, evenly distributed with stage lock engaged, worktable Z-position feedback for repeatable program run

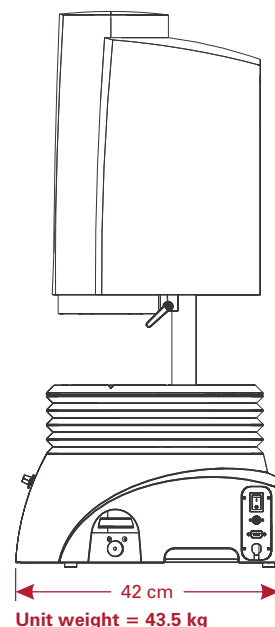
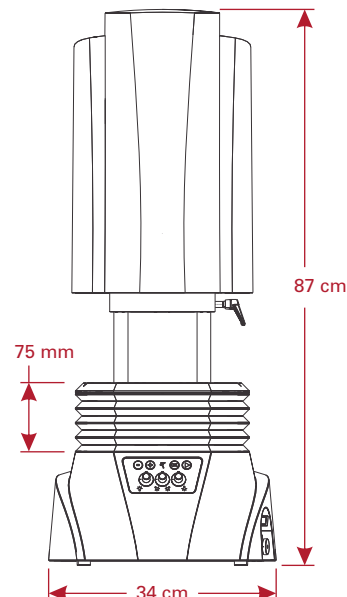

	Low Mag	High Mag
Feature Size	5 μ m	2 μ m
Repeatability (2σ)		
Accuracy (E₂)*	10 μ m + L/150*	5 μ m + L/150*

*Where L = length in mm. XY axis artifact: QVI Calibration Reticle P/N 640133 positioned in the center of the FOV in the standard measuring plane. The standard measuring plane is defined as a plane 5 mm above the maximum height of the worktable.

Operator Control Panel

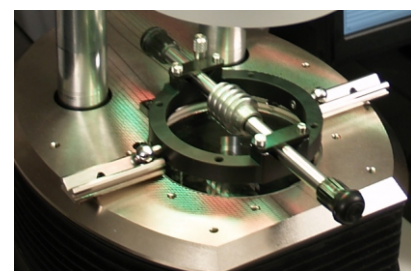
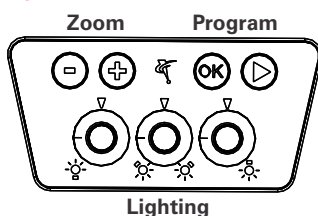

Optional Fixture Kit

Eight digital zoom magnifications

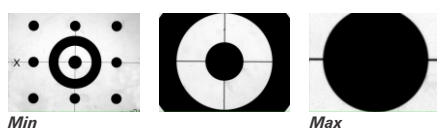

"Zoom Anywhere" capability

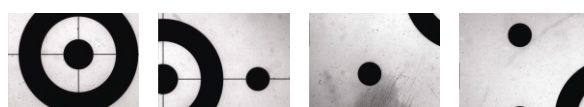

Available from:



Manufactured by:



Rochester, New York, USA